

**BACKING LOCATIONS**

**#12 X 2" SCREWS  
WITH ANCHOR PLUGS**

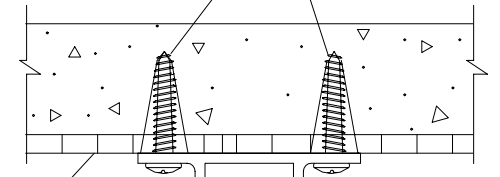

**FINISH WALL**

**#4000 BRACKET**

**# 14 x 1/2" SCREWS**

**#4030 "U" BRACKETS**

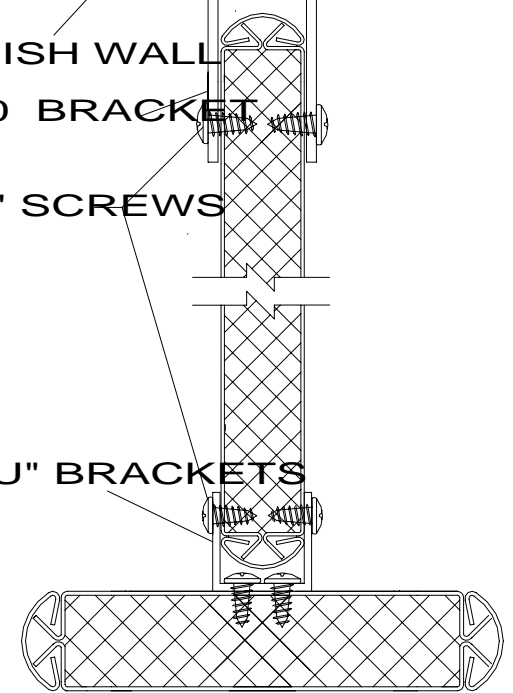

**ROCKVILLE  
PARTITIONS  
INCORPORATED**